

# YE-118XM

# DIN CABLE PLUG METAL SHIELD PUSH LOCKING ASS'Y

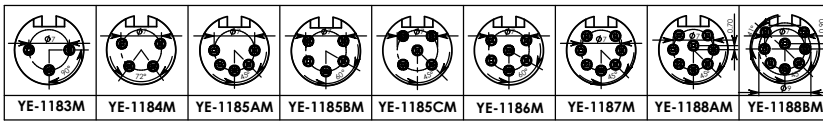
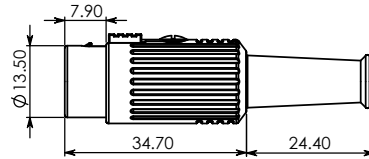
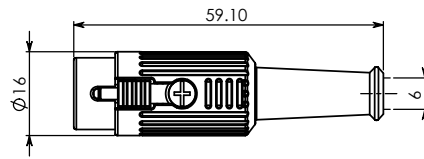

### MATERIAL :

1. SHIELD COVER : Zn ALLOY NICKEL PTD.
2. STRAIN BOOT : TPR
3. LEAF SPRING : STEEL
4. HOOK BUTTON : Zn ALLOY NICKEL PTD.
5. SET SCREW : STEEL NICKEL PTD.
6. "T" HOLDER : STEEL NICKEL PTD.
7. HOUSING : PA66
8. TERMINALS : BRASS SILVER PTD.

### SPECIFICATION :

Rating : 100V AC 1A max.

Contact Resistance :

Pins 30mΩ max.

Shell 50mΩ max.

Insulation Resistance :

100MΩ at 500V DC min.

Voltage Withstand :

250V AC for 1 minute



YE-1183M



YE-1184M



YE-1185AM



YE-1185BM



YE-1186M



YE-1187M



YE-1188AM



YE-1188BM